

Floor 0

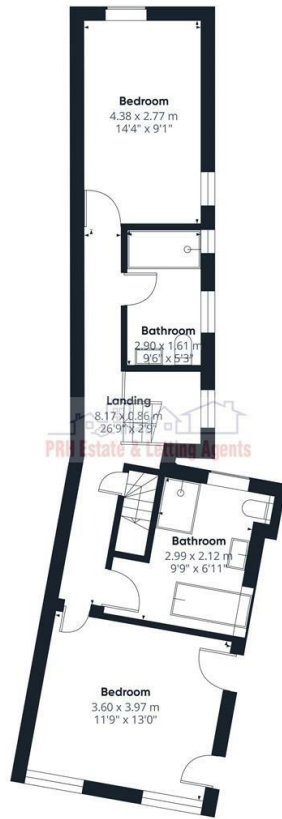

Floor 1



Floor 2



Penzance

£525,000



The accuracy of these particulars is not guaranteed nor do they form part of any contract. Applicants should verify details by personal examination and enquiry.

PRH is a trading name of PRH Lettings Limited. Registered office: 15 Alverton Street, Penzance, Cornwall, TR18 2QP. Registered in England No. 6667569



4 The Green Market, Penzance, Cornwall, TR18 2SH T: 01736 363816 E:mail@prhpenzance.co.uk

26 Chapel Street  
Penzance  
TR18 4AP

£525,000

## KEY FEATURES

- Freehold Grade II Listed
- Georgian Townhouse
- Prestigious Location
- Spacious Living
- Sea Views
- EPC Commissioned
- South Facing Garden
- Internet is Fibre to the property
- Ofcom suggest mobile coverage is good on most networks

## DIRECTIONS

From our Penzance Office turn right onto The Green Market and right again into Market Place which in turn leads to Chapel Street. Number 26 is located 3/4 of the way down on the right hand side of the road.

*Situated in the highly coveted and deeply historic heart of Penzance, Number 26 is a truly stunning Grade II listed Georgian townhouse that perfectly blends period elegance with coastal town living.*

*Steeped in character, this beautiful home features two spacious reception rooms boasting classic proportions, a well-appointed kitchen, three comfortable bedrooms, and two bathrooms. To the rear lies a delightful, private paved garden.*

*Currently operating as a highly successful holiday let, the property offers a turnkey investment opportunity or an exceptional permanent residence. Offered to the market with no onward chain, early viewing is highly recommended to appreciate the unique charm and prestigious location of this Georgian gem.*

*Freehold - SERVICES: Mains Gas, Electric, Water & Drainage - HEATING: Gas Central Heating and Underfloor heating in bathroom and shower room also a gas fire - COUNCIL TAX: As the property is a holiday let it is currently rated for Business Rates rather than a standard Council Tax Band - Ofcom suggest mobile coverage is good on most networks and that Ultrafast Broadband is available. The current connection is Fibre to the property.*

